

RESISTANCE THERMOMETER

for screwing in with connector



DRUCK & TEMPERATUR

For universal use in processes with liquid and gaseous media, at low and medium pressures.



Application

- Mechanical engineering
- Air conditioning and refrigeration technology
- Container and pipeline construction
- Storage temperature monitoring
- Apparatus construction
- Heating and furnace construction
- Engine monitoring

Type	8010	Options
Connection head	Connector GSP/GDM DIN EN 175301-803	
Operating temperature	-50°C up to +400°C, maximum 120°C at connector	others on request
Temperature sensor acc. DIN EN 60 751	1 x Pt 100 cl. F0,15 1 x Pt 100 cl. F0,3 2 x Pt 100 cl. F0,15 2 x Pt 100 cl. F0,3	others on request
Circuit types	2-wire 3-wire at 1 x Pt100 4-wire at 1 x Pt100	
Protection tube material	1.4571	others on request
Protection tube Ø d	6 mm	others on request
Thread G	G1/2A	G3/4A, G1A, others on request
Installation length L1	25, 100, 250 mm	others on request

Dimensional drawing, Dimensions in mm Terminal assignments

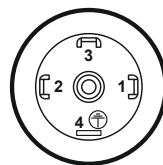
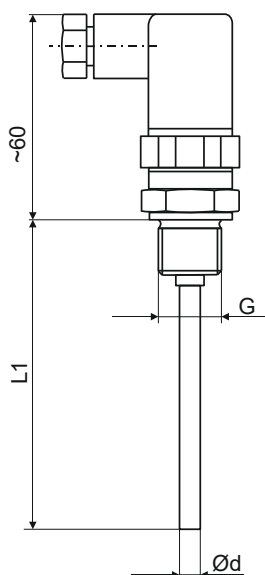

1 x Pt100
2-wire

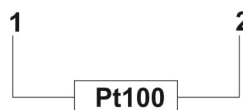

3-wire

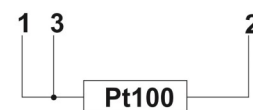

4-wire

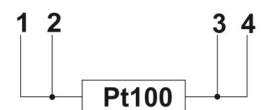

2 x Pt100 2-wire

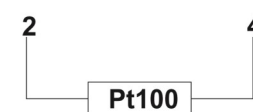
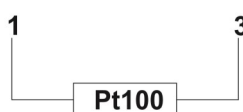

Type 8010