

DIFFERENTIAL PRESSURE GAUGE WITH CAPSULE ELEMENT

Nominal size 100

Accuracy class 1,6

Pressure connection 2 x hose screw fitting

Differential pressure manometer in robust design, with high reliability and long-term stability. Can be used for all gaseous, non-aggressive and dry media, which do not attack the measuring system and do not crystallise.

Applications:

Plant construction
Laboratory area
Filter monitoring



DRUCK & TEMPERATUR



Type	5900	Options
Nominal size	100	NS 63
Symbol		
Accuracy class	1,6 acc. to EN 837-3	
Ranges	0...25 mbar up to 0...400 mbar	
Application	Constant load: up to full scale value Alternating load: 90% of full scale value	
Permissible static pressure	5 x full scale value, max. 400 mbar on both sides	
Connection position	bottom	back
Case and mounting	Stainless steel with back flange	with 3-hole front flange
Bayonet ring	Stainless steel	
Window	Laminated safety glass	
Dial	Aluminium, white, scale and lettering black with zero point correction	
Pointer	Aluminium, black	
Movement	Copper alloy and nickel silver	
Measuring element	Copper beryllium alloy	
Pressure connection	2 x hose screw fitting 8 mm outside - 6 mm inside	
Protection	IP 65 acc. to EN 60529 / IEC 529	
Temperatures	Medium: -20°C up to 80°C Ambient: -25°C up to 60°C	
Weight	approx. 0,7 kg	

Type 5900

Dimensional drawing

Dimensions in mm

Connection bottom

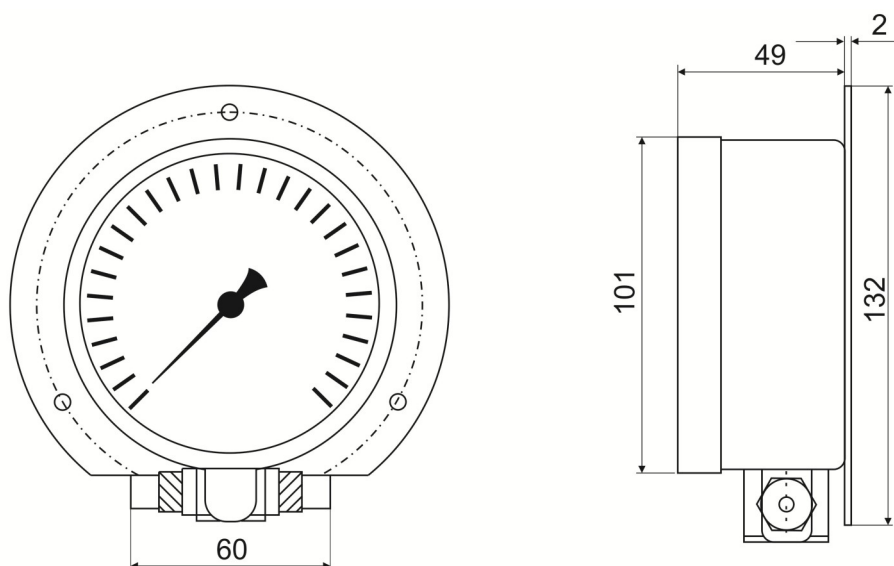

Connection back

