

DIFFERENTIAL PRESSURE GAUGE ALL STAINLESS STEEL WITH DIAPHRAGM with or without contact(s)



DRUCK & TEMPERATUR

Nominal size 100 and 160

PN10 / PN25

Accuracy class 1,6

The measuring system consists of a diaphragm and two separate pressure chambers. The pressure difference between the chambers causes the diaphragm to deflect axially. The movement is transmitted to the movement via a link rod. The devices are highly corrosion-resistant and highly overloadable.

Applications: Mechanical and plant engineering, chemical and petrochemical, power plant-, marine- and offshore technology



Type	5597	5598	Options
Nominal size	100	160	
Symbol			
Accuracy	± 1,6 % of full scale value		± 1,0 %
Differential pressure measuring ranges	0...25 mbar up to 0...25 bar; -40...60 mbar up to -1...0,6 bar		
Nominal pressure	PN 10 at measuring ranges ≤ 250 mbar PN 25 at measuring ranges ≥ 400 mbar		
Maximum pressure load	Constant load: Skalenendwert Alternating load: Skalenendwert Overload one-sided (+) and (-): 10 x full scale value ≤PN		
Bayonet case	1.4301, 1.4404		Safety case acc. to EN 837
Case filling	without		Glycerine, Silikone oil, at low action contact and inductive contact: Silikone, Paraffin oil Magnatic snap-action contact: Silikone oil
Process connection	2 x G1/4 female thread		Male thread G1/4, 1/4 NPT, 1/2NPT Femaile thread G1/2, 1/4 NPT, 1/2NPT Cutting ring screw connection (1.4571)
Connection material	1.4404		
Pressure chamber	1.4404		
Diaphragm	Measuring range ≤ 400 mbar 1.4571 Measuring range ≥ 600 mbar NiCrCo-Leg. DURATHERM®		O ₂ application
Bellows	NiCr.-Leg. Alloy 625		
Seal	Metal sealing		
Windows	Safety glass		
Movement	Stainless steel		
Dial and pointer	Aluminium coated, scale and lettering black		Special scales, Markpointer, peak registering pointer from 60 mbar
Protection class	IP 66 according to EN 60529		
Temperatures	Ambient: -20...+80°C, storage: -20...+80°C, medium: ≤ 100°C		
Mounting optional	Mounting plate for wall mounting or mounting plate and mounting bracket for pipe mounting		
Contacts (≥100 mbar) optional	Low action contacts, magnetic snap-action contacts, inductive contacts, Current output 0 ... 20 mA or 4 ... 20 mA		
Electrical connector	Cable socket (rated voltage 250V, cable gland M20x1.5)		

Type 5597, 5598

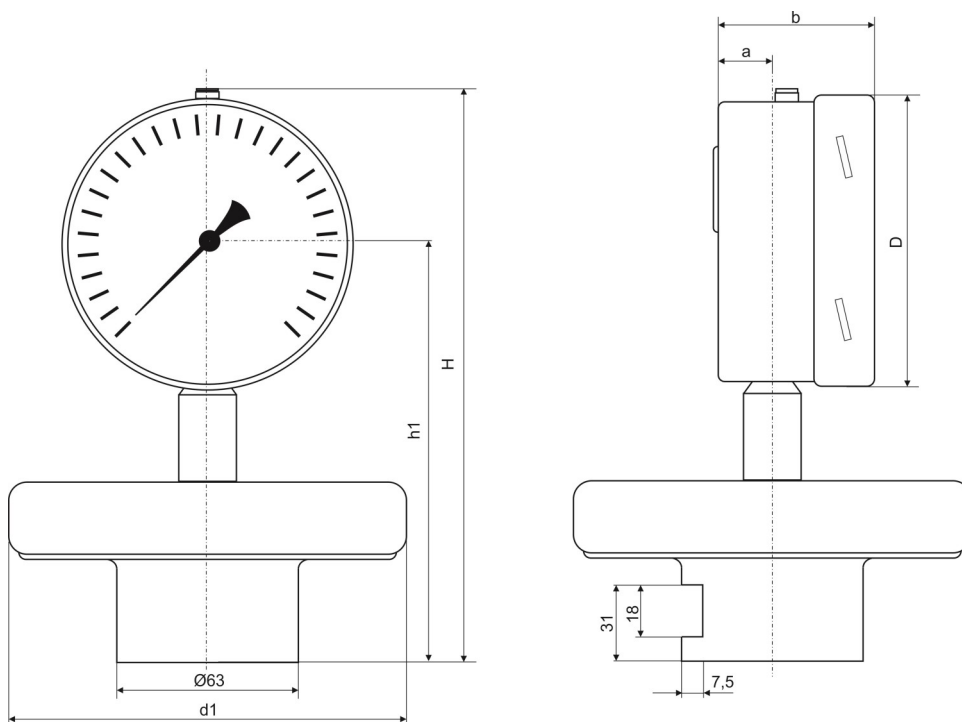

Measuring ranges 25...250 mbar

Type	NS	D	d1	H	h1	a	b
5597	100	101	138	199	145	15,5	53
5598	160	161	138	259	175	16,5	53,5

Mesasuring ranges 0,4...25 bar

Type	NS	D	d1	H	h1	a	b
5597	100	101	81	198	144	15,5	53
5598	160	161	81	258	174	16,5	54,5

