

# PRESSURE SENSOR WITH STAINLESS STEEL DIAPHRAGM



DRUCK & TEMPERATUR

**Pressure ranges 0...0,35 up to 0...600 bar**  
**Accuracy 0,5% FS**

The pressure sensor with a piezoresistive sensor element is characterized by high accuracy, reliability and stability.

## Applications

- Industry and mechanical engineering
- Pneumatics and hydraulics
- Oil and gas industry
- Chemical industry
- Plant engineering and automation technology



Type	3330	3335	3377	3378	Options
Pressure ranges	0...0,35 bar up to 0...600 bar				Vacuum and manovacuum meas. ranges
Output signal	4...20 mA 2-wire	0...10 V 3-wire	4...20 mA 2-wire	0...10 V 3-wire	0,5...4,5 V - 3-wire 0...5 V - 3-wire 1...5 V - 3-wire
Power supply	8...30 V DC	12...30 V DC	8...30 V DC	12...30 V DC	
Accuracy acc. to IEC 60770	±0,50 % FS including linearity, hysteresis und repeatability				±0,25 % FS
Thread	G 1/4 A ISO 1179-2		G 1/2 B EN 837		others on request
Electrical connection	Hirschmannstecker DIN 175301-803 A				DIN 175301-803 C Cable connection
Insulation resistance	500V DC				
Long-term stability	max. ±0,3%FS / year				
Load cycle	max. 10 <sup>7</sup>				
Temperatures	Medium: -10°C...+125°C Ambient: -10°C...+105°C Storage: -40°C...+125°C				
Case material	Stainless steel 316L				
Material wetted parts	Stainless 316L				
Rectangle sealing ring	Viton				
Impact resistance	100g/11ms according to IEC 60067-2-27				
Vibration resistance	10g (@20Hz-200Hz) according to IEC 60068-2-6				20g
Protection class	IP65				
Weight	Welded (up to 200 bar) ≤150 g , Assembled (250 bar up to 600 bar) ≤200 g				

Type 3330, 3335, 3377, 3378

## Dimensional drawings types 3330 and 3335

Dimensions in mm

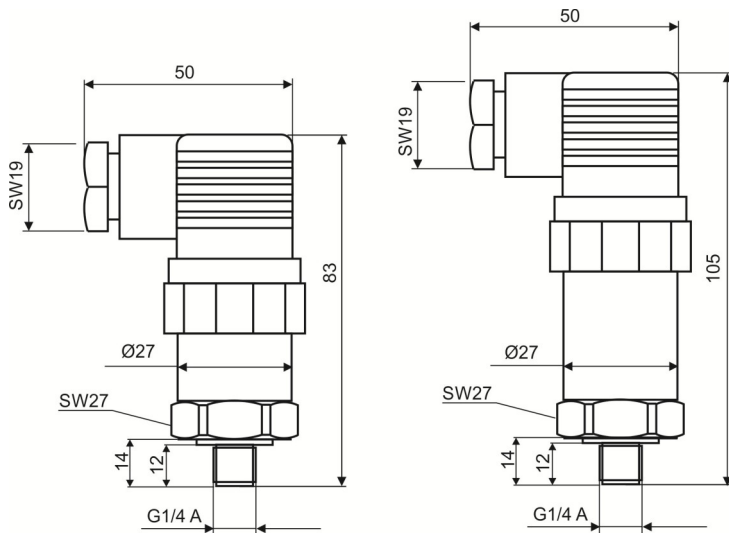

0...0,35 up to 0...200 bar

0...250 up to 0...600 bar

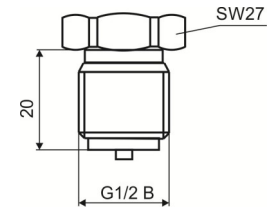

Thread G1/2B  
Types 3377 and 3378

## Electrical connection DIN 175301-803-A

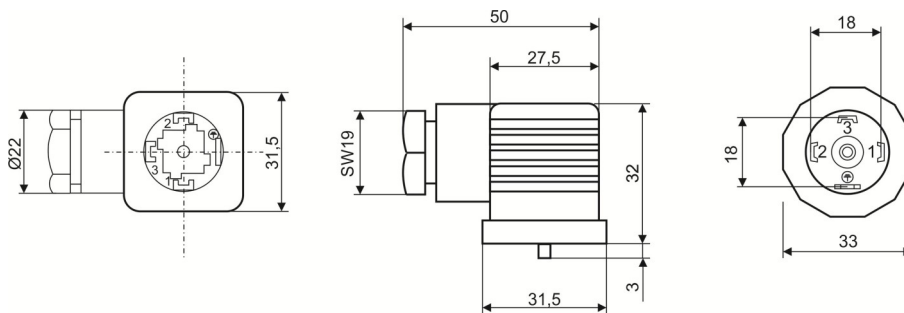

## Connection diagram

Pin	2-wire	3-wire
1	UB+ (+V)	UB+ (+V)
2	out (0V/+OUT)	UB- (GND)
3	nc Null	out (+OUT)

## Pressure ranges and limits (bar)

Range	max. overpressure	burst pressure
0...0,35	1	5
0...0,6	1,8	5
0...1	3	5
0...1,6	3	5
0...2,5	5	10
0...4	8	12
0...6	12	20
0...10	20	30
0...16	30	60
0...25	50	75
0...40	80	120
0...60	120	180
0...100	200	300
0...160	300	400
0...200	300	400
0...250	400	500
0...400	600	800
0...500	750	1000
0...600	750	1000

## SUKU Druck- und Temperaturmesstechnik GmbH

Gamsdorfer Hauptstraße 109 • 09244 Lichtenau / Sachsen - GERMANY  
Tel.: +49 37208 / 2717 • Fax: +49 37208 / 61713 • contact@suku.de • www.suku.de