

# DIAPHRAGM CHEMICAL SEAL TYPE



## Process connection

### Flange

acc. to DIN 1092-1 or

acc. to ANSI B 16.5

Diaphragm seals transmit the process pressure to the pressure measuring device, with the diaphragm seal hermetically separating the medium and the measuring device.

Diaphragm seals of this series are suitable for aggressive, contaminated and hot media.

A large number of common pressure gauges can be equipped with these diaphragm seals, as can pressure switches and transmitters.



Type	1005		Options
Process connection	acc. to DIN EN1092-1	acc. to ASME B16.5	
Diaphragm seal	1.4404 (316L)		
Device connection	G 1/2 female		Drilling d8 for welding with a pressure gauge with process connection d8x5, version with capillary line or with cooling element, others on request
Diaphragm	Sinusoidal shape, 1.4435 (316L)		Tantalum, Hastelloy C276, Monel 400, PTFE.....
Material sealing strip	316L		Tantalum, Hastelloy C276, Monel 400, PTFE.....
Flange	316L		Tantalum, Hastelloy C276, Monel 400, PTFE.....
Effective membrane diameter	See page 2		
Sealing face	acc. to DIN EN 1092-1 Form B, sealing face B2, stamped B2	ASME RJF-circular groove	
Nominal pressure	See page 2		
Temperatures	Medium: -20°C up to 200°C		up to 400°C
Filling liquid	Oil		

Type 1005

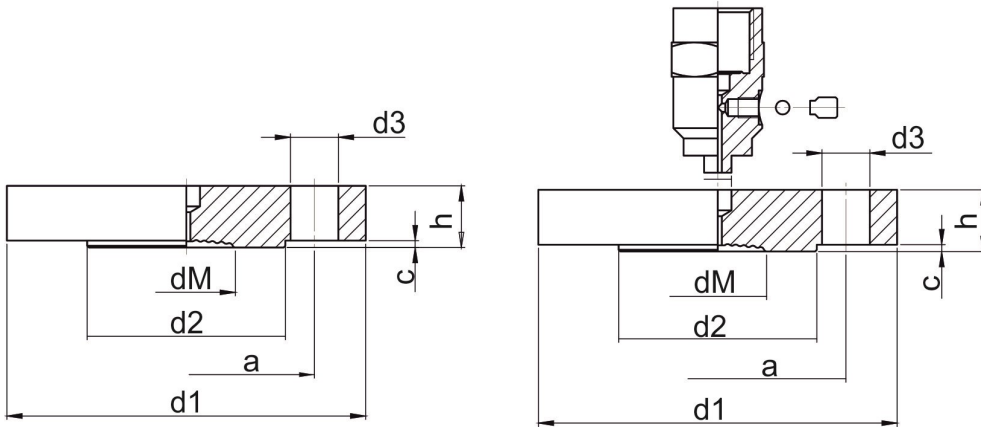

EN 1092-1								
DN	PN	dM	d1	h	d3	a	c	d2
25	10/40	34	115	16	4 x 14	85	2	68
32	10/40	38	140	16	4 x 14	100	2	78
40	10/40	48	150	18	4 x 18	110	3	88
	63/100	48	170	26	4 x 22	125	3	88
	160	48	170	28	4 x 22	125	3	88
50	25	48	185	34	4 x 26	135	3	88
	10/40	59	165	20	4 x 18	125	3	102
	63	59	180	26	4 x 22	135	3	102
	100	59	195	28	4 x 26	145	3	102
	160	59	195	30	4 x 26	145	3	102
	250	59	200	38	8 x 26	150	3	102

ANSI B16.5								
DN	PN	dM	d1	h	d3	a	c	d2
3/4"	150	28	100	22	4 x 16	70	2	43
	300	28	120	22	4 x 20	82,5	2	43
1"	150	38	110	22	4 x 16	79,5	2	51
	300	38	125	22	4 x 20	89	2	51
1 1/2"	150	48	130	22	4 x 16	98,5	2	73
	300	48	155	22	4 x 22	114,5	2	73
	600	48	155	29,5	4 x 22	114,5	7	73
	1500	48	180	39	4 x 30	124	7	73
	2500	48	205	51,5	4 x 33	146	7	73
2"	150	59	150	20	4 x 20	120,5	1,6	92
	300	59	165	22,5	8 x 20	127	1,6	92
	600	59	165	32	8 x 20	127	6,4	92
	1500	59	215	45	8 x 26	165	6,4	92
	2500	59	235	57,5	8 x 30	171,5	6,4	92

Other sizes and pressure ratings on request